

PLEASE PROVIDE THE FOLLOWING:

1. INLET STYLE A or B or C (STYLE A IS MORE COMMON; EXTRA COST FOR STYLE C.)

2. INSIDE NEEDLE GAUGE* (SMALLEST INSIDE GAUGE IS 28G) _____ G

3. MIDDLE NEEDLE GAUGE* _____ G

4. OUTSIDE NEEDLE GAUGE* _____ G
 *CONSULT NEEDLE GAUGE CHART - ALLOW FOR SPACE BETWEEN NEEDLES.

5. DIM C1 (IF C1=0, THEN FLUSH) _____ MM

6. DIM C2 (IF C2=0, THEN FLUSH) _____ MM

NOTE DIM D IS APPROX. 45MM FOR TRIAXIAL DESIGN.

7. DIM E _____ MM (MIN 25MM FOR STYLES A AND C; MIN 5MM FOR B; MAX 120MM FOR A AND B, 100MM FOR C)

8. DIM F* _____ MM (MIN 2MM; RECOMMENDED 10-30MM; *MAX 75MM IF ALL GAUGES ARE EVEN; 30MM MAX IF ANY GAUGE IS ODD OR IF INSIDE IS 28G)

DISASSEMBLY OPTION FOR CLEANING IS NOW STANDARD.

9. ADD BEVELED TIP? _____ (Y OR N) (EXTRA COST)

10. INLET STEMS OPPOSING _____ (Y OR N). IF YES, THEN AS SHOWN; IF NO, THEN PARALLEL AND SAME SIDE. YES (OPPOSING AS SHOWN) IS MORE COMMON AND REQUIRED FOR STYLE C INLET.

ANY ADDITIONAL SPECIAL REQUIREMENTS?

- NOTES:
1. SHAFT MATERIAL: TYPE 304 STAINLESS STEEL.
 2. HUB MATERIAL: CHROME AND ZINC PLATED BRASS.
 3. NEEDLE TIP: PROBE POINT - SQUARE. BEVELED TIP OPTIONAL.
 4. PER VIEW A, INSIDE NEEDLE TO BE MADE CONCENTRIC TO OUTSIDE NEEDLE.

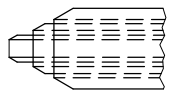

BEVELED TIP OPTION SCALE 4:1



VIEW A SCALE 4:1

THIS WORKSHEET CAN BE FOUND AT http://www.ramhart.com/pdf/triaxial_worksheet.pdf

ramé-hart instrument co.			
19 RT 10 E, ST 11 - SUCCASUNNA - NJ 07857 PH 973-448-0305 ramhart.com			
TOLERANCES UNLESS OTHERWISE NOTED 0.00±0.010in (0.25mm) 0.000±0.005in (0.127mm) ANGLES ±0°30'			
DRAWN BY	CHECKED	DATE	SCALE
CC	WA	18-NOV-2014	NTS
CUSTOM TRIAXIAL NEEDLE			
TITLE	DWG NO	REV	
TRIAxIAL	100-10-TRIAxIAL	G	