

- NOTES:**
1. SHAFT MATERIAL: TYPE 304 STAINLESS STEEL.
 2. HUB MATERIAL: CHROME AND ZINC PLATED BRASS.
 3. NEEDLE TIP: PROBE POINT - SQUARE. BEVELED TIP IS OPTIONAL.
 4. PER VIEW A, INSIDE NEEDLE TO BE MADE CONCENTRIC TO OUTSIDE NEEDLE.

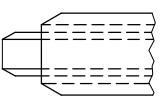

BEVELED TIP OPTION
SCALE 4:1



VIEW A
SCALE 4:1

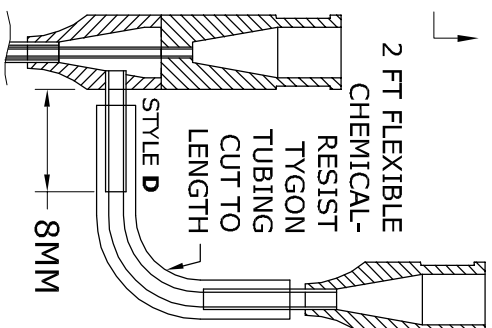

THIS WORKSHEET CAN BE FOUND AT http://www.ramehart.com/pdf/coaxial_worksheet.pdf

PLEASE PROVIDE THE FOLLOWING:

1. INLET STYLE A, B, C OR D (SIDE INLET FOR OUTER FLOW; STYLE A MOST COMMON; B CONNECTS TO 1/16 INCH OD TYGON TUBING; EXTRA COST FOR STYLE C, D)

2. INSIDE NEEDLE GAUGE* (SMALLEST GAUGE IS 28G; EXTRA COST FOR 27-28G) _____ G

3. OUTSIDE NEEDLE GAUGE* ***CONSULT NEEDLE GAUGE CHART - OD OF INNER NEEDLE MUST BE LESS THAN ID OF OUTER NEEDLE.** _____ G

4. DIM C _____ MM (IF DIM C IS 0, THEN BOTH NEEDLES WILL END AT SAME PLANE; DIM C = 0 IS MOST COMMON. USE POSITIVE VALUE TO HAVE INSIDE TUBING LONGER THAN OUTSIDE; USE NEGATIVE VALUE TO HAVE INSIDE TUBING SHORTER THAN OUTSIDE.)

NOTE DIM D IS APPROXIMATELY 30MM AND IS NOT ADJUSTABLE.

5. DIM E _____ MM (MIN 25MM FOR STYLES A & C; MIN 5MM FOR STYLE B; MAX 120MM FOR STYLES A & B; MAX 75MM FOR STYLE C; FOR STYLE D, DIM E = 8MM PLUS 2 FT TUBING).

6. DIM F* _____ MM (MIN 2MM; RECOMMENDED 10-30MM) ***MAX 90MM FOR EVEN NUMBERED GAUGES (EG, 10G, 12G, 14G, 16G, ETC.) AND 35MM FOR ODD GAUGES (EG, 11G, 13G, 15G, 17G, ETC.).**

7. DISASSEMBLY FOR CLEANING AT POINT "SP" IS STANDARD.

8. EXTRA INNER NEEDLE? (Y OR N) _____ (EXTRA COST)

9. ADD BEVELED TIP? (Y OR N) _____ (EXTRA COST)

raméhart instrument co.

19 RT 10 E, ST 11 - SUCCASUNNA - NJ 07857 PH 973-448-0305 [ramehart.com](http://www.ramehart.com)

TOLERANCES UNLESS OTHERWISE NOTED

0.00±0.010in (0.25mm) 0.000±0.005in (0.127mm) ANGLES ±0°30'

DRAWN BY	CHECKED	DATE	SCALE
CC	WA	8-DEC-2020	NTS

CUSTOM COAXIAL NEEDLE

TITLE	DWG NO	REV
COAXIAL	100-10-COAXIAL	J